

PLUMBSHOP®

STAINLESS STEEL GAS CONNECTORS INSTALLATION INSTRUCTIONS

For Residential and Commercial Gas Appliances

THE SAFE, EASY WAY TO INSTALL HOME GAS APPLIANCES.

Stainless steel gas appliance connectors provide a safe and easy method to install gas ranges, water heaters, ovens, furnaces and gas dryers. The corrugated tube allows the flexibility you need to align the appliance to the rigid gas supply pipe.

- ❑ Approved for use with natural, manufactured, L.P. (propane), and L.P. air mixture gases with internal line pressure no greater than 1/2 lb. per square inch (psi).
- ❑ Design certified by CSA, and listed by the New York City Board of Standards and Appeals and the Commonwealth of Massachusetts.
- ❑ Appliance connectors sold without end fittings are not CSA design certified.
- ❑ 100% leak tested.

⚠ CAUTION: DO NOT INSTALL THIS PRODUCT UNTIL YOU READ AND UNDERSTAND ALL INSTRUCTIONS. FAILURE TO FOLLOW THESE INSTRUCTIONS MAY RESULT IN PERSONAL INJURY, PROPERTY DAMAGE OR PRODUCT FAILURE.

Even an outstanding system can become a hazard due to poor installation, inspection or testing. Please read all precautions and installation instructions before beginning connector installation.

SAFETY PRECAUTIONS:

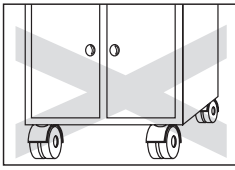
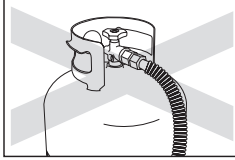
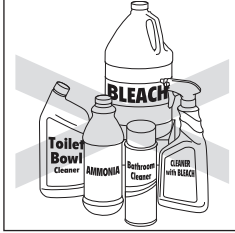
- ⚠ **DANGER:** Read and Understand All Precautions Carefully Before Installing
- ❑ **WARNING:** Gases can be ignited by a flame or spark, which may result in an explosion. Please follow installation instructions carefully. When in doubt, call a licensed plumber or your local gas company.
- ❑ **WARNING:** DO NOT re-use connectors, fittings and valves; they are designed for use on original installation only. Removal of connector and additional handling may damage connector making it unsafe for reuse.
- ❑ **WARNING:** DO NOT use this connector if it has been in a fire. Fire can damage the connector making it unsafe for use.
- ❑ **WARNING:** DO NOT use this connector on appliances equipped with rollers or casters. This connector is designed for limited movement after installation. Repeated bending, flexing or extreme vibration can cause metal fatigue. Normal vibration and movement of standard household gas dryer or similar appliance is okay. 
- ❑ **WARNING:** DO NOT use connectors to make a direct connection to LP gas containers. Connection MUST be made to the regulator device only. 
- ❑ **WARNING:** DO NOT use connector on appliances in moving vehicles such as RV's, trailers, etc. However, this product may be used in manufactured housing (permanent residence mobile homes).
- ❑ **WARNING:** DO NOT use this connector with infrared radiant tube heaters. Cyclic movement of heater may cause connector to fail.
- ❑ **WARNING:** Keep cleaning solvents containing ammonia or chlorine away from gas connector. DO NOT store these solutions near connector or use the connector near a swimming pool or hot tub. Water rinse the connector thoroughly if exposed to these chemical products. 
- ❑ **WARNING:** DO NOT join this connector to another connector.
- ❑ **WARNING:** DO NOT stretch connector to make it fit. Connector must be at least 2 in. to 3 in. longer than the farthest anticipated connected distance from the gas supply without stretching, twisting or bending smaller than a 1-1/2 in. internal diameter.
- ❑ **WARNING:** DO NOT trap connector against sharp edges or corners.
- ❑ **WARNING:** DO NOT kink, twist or bend connector sharply.

⚠ WARNING: Connector is for use in accessible locations only. DO NOT conceal connector or run connector through enclosed outdoor BBQ pits, walls, partitions, floors or appliance panels.

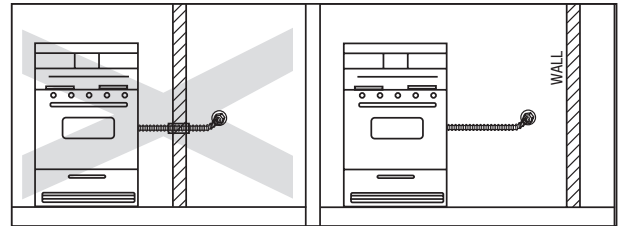

❑ **WARNING:** DO NOT connect gas connector nuts directly to pipe threads of gas supply pipe or appliance. Install connector using the fittings provided. (see Figure A)

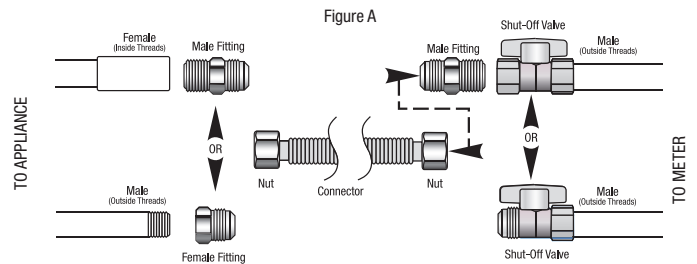

CODES AND REGULATIONS

Gas appliance and connector installation MUST conform with all local codes and regulations including municipal and state building codes, and to all local utility regulations. In the absence of local code, the installation must conform with the National Fuel Gas Code ANSI Z223.1/ NFPA No. 54, Uniform Plumbing Code, or International Fuel Gas Code. Contact your local gas company for details.

INSTALLATION INSTRUCTIONS:

⚠ WARNING: Turn off gas supply before disconnecting old appliance. In absence of manual shut-off valve near appliance location, gas MUST be shut off at main valve, near meter.

NOTE: Fuel gas codes require installation of a manual shut-off valve in the same room, within easy reach of the appliance (i.e. within 6 feet).

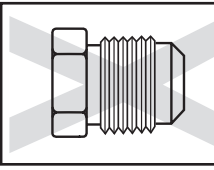
1. Clean all pipe threads with a wire brush and rag to ensure connections are free of any debris such as metal shavings, rust, dirt, oil or water.
2. Apply pipe thread sealant to the male pipe threads of connection. DO NOT apply sealant or tape to flare ends of fittings or shut-off valve. Sealant and tape will prevent this connection from sealing properly.
3. If necessary, thread new manual shut-off valve onto gas supply pipe, wrench tighten. 
4. Thread steel fitting to manual shut-off valve and other steel fitting onto appliance regulator.
5. Thread flare nuts of gas connector onto shut-off valve and steel fitting. Wrench tighten all connections.

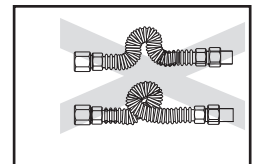

6. Turn manual shut-off valve on to allow gas to enter system.

⚠ WARNING: DO NOT TURN ON APPLIANCE until all connections have been leak tested!

⚠ WARNING: DO NOT USE matches, candles, open flames or other sources of ignition to leak test connections!

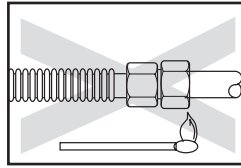

7. Test all connections with leak test solution, or with clear soap and water solution; bubbles will indicate a leak. If a leak is detected, turn off gas supply before further tightening connections. Water rinse and towel dry connector once test is complete.

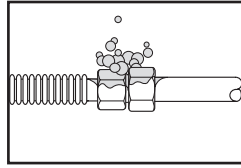

8. Wait at least 10 minutes to be certain that all vapors have dissipated. If leak test confirms connections do not leak gas, and you do not smell any gas, **THEN light pilot(s) and turn on appliance.**

Tools Needed for Installation:

- (2) 10 in adjustable wrenches
- Pipe dope or gas pipe thread tape
- Leak detection solution

Gas Connector Maximum Flow Capacity										
Part #	ID Color Code		12 in	18 in	24 in	30 in	36 in	48 in	60 in	72 in
Gas Connector with Standard Fittings										
CSSL	1/4	BTU's	48,000	43,800	40,000	36,400	33,400	28,300	24,900	23,100
	Purple	Watts	14,067	12,837	11,723	10,668	9,789	8,294	7,297	6,770
CSSD	3/8	BTU's	102,000	93,100	85,000	77,100	71,100	60,500	53,200	49,100
	Green	Watts	29,893	27,285	24,911	22,596	20,837	17,731	15,591	14,390
CSSC	1/2	BTU's	180,000	164,200	150,000	136,000	125,000	106,000	93,200	86,000
	Gold	Watts	52,752	48,122	43,961	39,858	36,634	31,066	27,314	25,204

***Note:** Connecting the safety valve lowers these values below the Z21.24/CSA 6.10 and Z21.75/CSA 6.27 standards

Listings & Certifications:

Components CSA listed to ANSI Z21.24 / CSA 6.10 standard "Connectors for Gas Appliances"

Components CSA listed to ANSI Z21.75 / CSA 6.27 standard "Connectors for Outdoor Gas Appliances & Manufactured Homes"

NOTE: This connector meets or exceeds the minimum allowable capacity as determined under test conditions specified in ANSI Z21.24 • CSA 6.10. Straight length capacity rated in BTU per hr. using: 0.64 SP. Gr., 1000 BTU per Cu Ft. Gas at 0.50 inch Water Column Pressure Drop. The capacity at 50 Pa (0.2 inch water column) pressure drop can be determined by multiplying the BTU per hr. listed in the table above by 0.632.



PLUMBSHOP® By Brasscraft Manufacturing Co.

Manufacturer assumes no responsibility for failure due to improper installation.
 ©2019 Brasscraft Manufacturing Company, Novi, MI 48375-5331 U.S.A. All Rights Reserved. www.plumbshop.com
 Plumbshop® brand is a trademark of Brasscraft Mfg. Co.